

ELECTRICAL LIGHTING, POWER & FIRE ALARM PLAN  
SCALE: 1/4" = 1'-0"

LIGHTING PLAN NOTES

- ① EXISTING RECESSED DOWNLIGHT RELOCATED TO NEW REFLECTED CEILING LOCATION. THE CONTRACTOR SHALL PROVIDE ALL NECESSARY EXISTING BRANCH CIRCUIT EXTENSIONS REQUIRED TO POWER AND CONTROL THE FIXTURE. PROVIDE ALL NECESSARY APPURTENANCES REQUIRED FOR A COMPLETE AND FUNCTIONAL INSTALLATION. REFER TO ARCHITECTURAL REFLECTED CEILING PLAN FOR LIGHT FIXTURE NEW LOCATION.
- ② REWIRE EXISTING L.E.D. WAYFINDING SIGN ELECTRICAL WIRING THROUGH NEW WINDOW MULLION TO NEW SIGN LOCATION.

POWER PLAN NOTES

- ① EXISTING JUNCTION BOX IN CEILING BELOW PREVIOUSLY PROVIDING POWER TO THE EXISTING POWER PEDESTAL FLOOR MOUNTED DEVICES. CAP EXISTING CONDUITS FLUSH TO THE FLOOR AND SEAL. PROVIDE ALL NECESSARY APPURTENANCES REQUIRED FOR A COMPLETE AND FINISHED APPEARANCE TO THE SATISFACTION OF THE ARCHITECT.
- ② NEW SURFACE MOUNTED POWER PEDESTAL FLOOR BOX AND DEVICE AT RELOCATED PASSENGER BOARDING PODIUM. FIELD COORDINATE THE EXACT LOCATION WITH THE ARCHITECT PRIOR TO SLAB CORE-DRILL AND ROUGH-INS.
- ③ NEW 3/4" POWER EXISTING BRANCH CIRCUITRY EXTENSIONS BELOW FLOOR SLAB TO THE EXISTING AND NEW POWER PEDESTAL FLOOR BOX AND DEVICE LOCATION. PROVIDE ALL NECESSARY RE-CONNECTION OF THE EXISTING BRANCH CIRCUIT SERVICE AS REQUIRED FOR A COMPLETE AND FUNCTIONAL INSTALLATION.
- ④ NEW SURFACE MOUNTED POWER AND PEDESTAL FLOOR BOXES AND DEVICES AT THE CHECK-IN PODIUM AND BACKSCREEN. FIELD VERIFY EXISTING PEDESTAL FLOOR BOX MODELS INSTALLED AND MATCH FOR UNIFORMITY OF CONSTRUCTION STYLE. FIELD COORDINATE THE EXACT LOCATION WITH THE ARCHITECT PRIOR TO ROUGH-INS.
- ⑤ FIELD COORDINATE THE ROUTING OF THE NEW BRANCH CIRCUITRY BACK TO EXISTING PANEL '3CPA' PRIOR TO INSTALLATION TO AVOID CONFLICT WITH OTHER EXISTING UTILITIES.

FIRE ALARM PLAN NOTES

- ① INSTALL ON COLUMN AS INDICATED ONE NEW STROBE-ONLY FIRE ALARM INDICATING DEVICE AND ONE RELOCATED STROBE AT THE EXISTING COLUMN LOCATION. FIELD ADJUST THE PROPER CANDELA RATINGS REQUIRED AS NECESSARY TO PROVIDE APPROPRIATE COVERAGE. CONNECT TO THE EXISTING FIRE ALARM STROBE CIRCUIT SERVING THE PREVIOUS COLUMN MOUNTED DEVICE RELOCATED UNDER THE DEMOLITION PHASE OF THE PROJECT. THE CONTRACTOR SHALL TEST THE INDICATING ALARM CIRCUIT TO CONFIRM CAPACITY TO HANDLE THE ADDITION STROBE INSTALLATION. PROVIDE ALL NECESSARY APPURTENANCES REQUIRED FOR A COMPLETE AND FUNCTIONAL INSTALLATION.

GENERAL FIRE ALARM NOTES

1. GENERAL
  - A. THESE DRAWINGS ARE SCHEMATIC AND INTENDED TO DEPICT THE GENERAL LOCATION OF ELECTRICAL SYSTEM COMPONENTS. CONSULT ARCHITECTURAL PLANS FOR FINAL DIMENSIONS AND LOCATION OF FIXTURES, DEVICES AND EQUIPMENT.
  - B. THE INSTALLATION OF ALL ELECTRICAL WORK SHALL BE IN ACCORDANCE WITH ALL CODES AND AUTHORITIES HAVING JURISDICTION INCLUDING, BUT NOT LIMITED TO, THE FOLLOWING:
    - 1. THE LATEST VERSION OF N.E.C., AND LOCAL JURISDICTION AMENDMENTS.
    - 2. ALL LOCAL CODES.
    - 3. NFPA 72 AND THE LATEST VERSION OF THE LOCALLY RECOGNIZED BUILDING CODE.
    - 4. THE AMERICANS WITH DISABILITIES ACT (ADA).
    - 5. THE 2003 IECC CODE.
  - D. ADVANCE NOTICE SHALL BE GIVEN TO MWAA BEFORE COMMENCEMENT OF WORK ON ANY ELECTRICAL CIRCUITRY, WHETHER OR NOT AN OUTAGE IS REQUIRED.
  - E. UNLESS SPECIFICALLY NOTED ON THE PLANS, ALL CIRCUITRY, EQUIPMENT, DEVICES, ETC., NOT NOTED AS EXISTING TO REMAIN OR TO BE RELOCATED, SHALL BE NEW. ALL CIRCUITS THAT ARE TO REMAIN IN SERVICE UPON COMPLETION OF THIS PROJECT MUST BE CONTINUED IN SERVICE. OUTAGES ON EXISTING CIRCUITS TO REMAIN SHALL BE COORDINATED WITH THE MWAA.
  - F. CONTRACTOR SHALL SUBMIT SHOP DRAWINGS FOR ALL EQUIPMENT DEVICES AND OTHER ASSOCIATED APPURTENANCES TO BE PROVIDED FOR THIS PROJECT INCLUDED BUT NOT LIMITED TO:
    - 1. FIRE ALARM DEVICES
2. FIRE ALARM
  - A. CONTRACTOR SHALL PROVIDE ALL THE DEVICES, CONTROL AND EXTENDER PANELS, POWER SUPPLIES, WIRING, ETC. AS REQUIRED FOR THE INSTALLATION OF A COMPLETE, CODE COMPLIANT AND OPERATIONAL FIRE ALARM SYSTEM IN THE AREA OF WORK.
  - B. THE CONTRACTOR SHALL PREPARE ALL SHOP DRAWINGS, EQUIPMENT CUTS AND DETAILING AND SUBMIT SAME TO THE LOCAL FIRE MARSHALL AND RECEIVE APPROVAL PRIOR TO THE START OF WORK. THE CONTRACTOR SHALL ASSUME THAT ELECTRONIC COPIES OF DRAWINGS ARE NOT AVAILABLE.
  - C. A MWAA APPROVED ELECTRICAL CONTRACTOR SHALL CONNECT ALL NEW BUILDING FIRE ALARM DEVICES TO THE EXISTING BUILDING FIRE ALARM SYSTEM IN ACCORDANCE WITH THE EXISTING FIRE ALARM SPECIFICATION AND PER CODE. ALL FIRE ALARM DEVICES INDICATED ON THESE PLANS AS NEW SHALL MATCH THE EXISTING DEVICES IN ALL RESPECTS. THE CONTRACTOR SHALL NOT DISABLE THE FIRE ALARM SYSTEM WITHOUT MAKING PRIOR ARRANGEMENTS WITH THE BUILDING OWNER. THE CONTRACTOR SHALL BE RESPONSIBLE FOR PROVIDING ALL PROVISION REQUIRED BY THE OWNER AND LOCAL AUTHORITIES DURING ANY INTERRUPTION OF FIRE ALARM SERVICE. THE CONTRACTOR SHALL LEAVE ALL DEVICES FULLY OPERATIONAL.
  - D. NEW FIRE ALARM SYSTEM FLASHING LIGHTS SHALL BE IN ACCORDANCE WITH ADA IN TYPE, COLOR, FLASH RATE, LIGHT INTENSITY AND MOUNTING HEIGHT AND LOCATION. THE CONTRACTOR SHALL BE RESPONSIBLE FOR DETERMINING AND PROVIDING WHAT MODIFICATIONS, IF ANY, SHALL BE NECESSARY TO THE BASE BUILDING FIRE ALARM SYSTEM TO ACCOMMODATE THE REQUIRED NEW DEVICES IN THIS CONTRACT.
  - E. ALL FIRE ALARM STROBE LIGHTS SHALL BE SYNCHRONIZED. PROVIDE SYNCHRONIZATION MODULE(S) IN APPROPRIATE MODIFIED APPLIANCE CIRCUIT(S) AS NECESSARY.

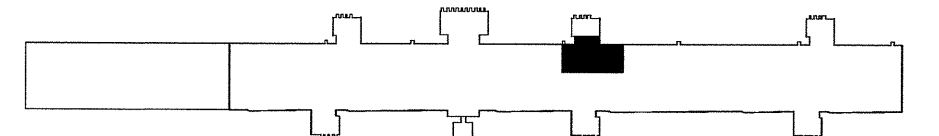

NO.	REVISION	DATE

**PGAL**  
201 N. UNION ST.  
SUITE 500  
ALEXANDRIA, VIRGINIA 22314  
(T) 703 836 0588  
(F) 703 836 8027

DATE August 31, 2011  
SCALE 1/4" = 1'-0"  
DESIGNED DLW  
CHECKED RDZ DRAWN DLW  
ACCEPTED BJL  
SUBMITTED DRH  
APPROVED FDH

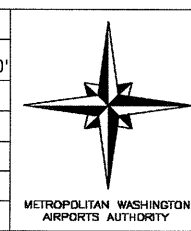

**METROPOLITAN WASHINGTON AIRPORTS AUTHORITY**  
  
OFFICE OF ENGINEERING DESIGN DEPARTMENT

GATE A23/25 - A31  
STERILE CORRIDOR RENOVATION  
WASHINGTON DULLES INTERNATIONAL AIRPORT  
WASHINGTON, DC

**ELECTRICAL LIGHTING, POWER, & FIRE ALARM PLAN**

PROJECT IDENTIFIER IT1111  
SHEET NAME EL03.001  
VOLUME NUMBER 1 of 1  
SHEET NUMBER 18 of 35